

## 1. Check App Management.

Please check your APP management, the address should be the same as the following picture. If not, please modify it.

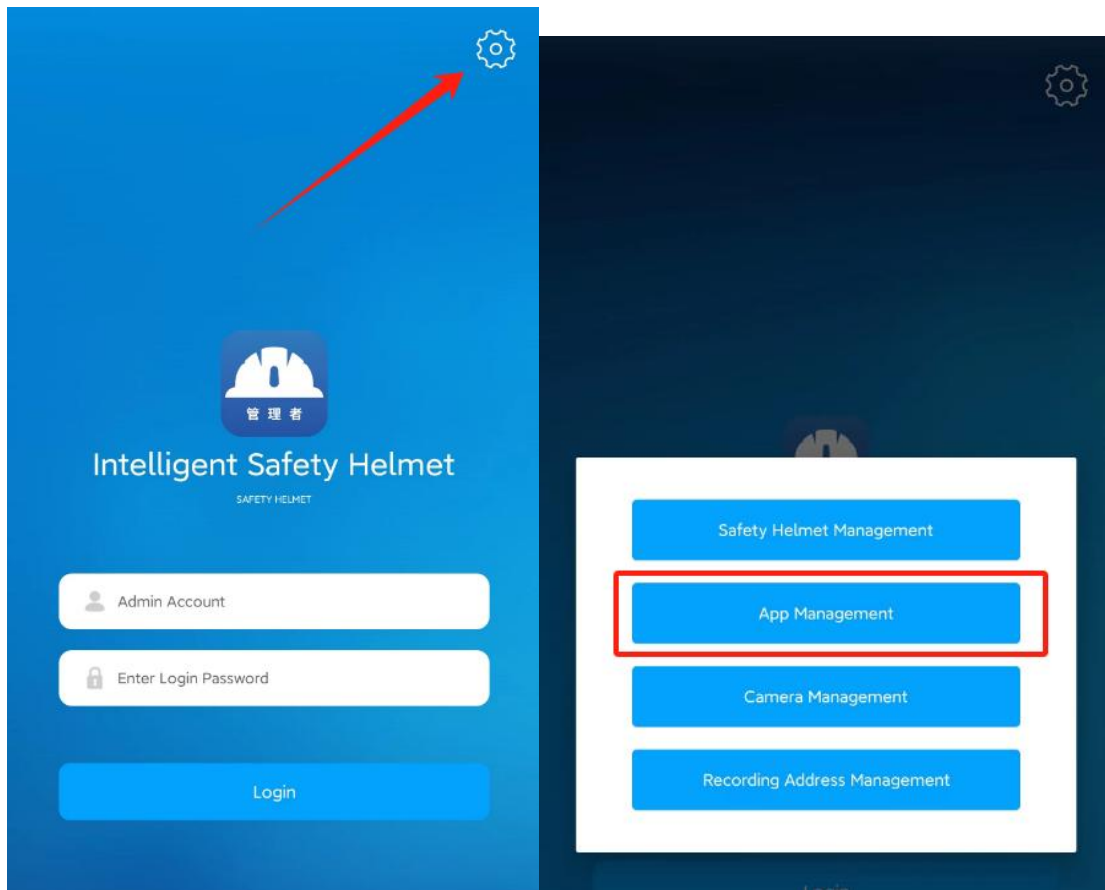

<http://47.242.181.51:10007/api/>  
<ws://47.242.181.51:10000>

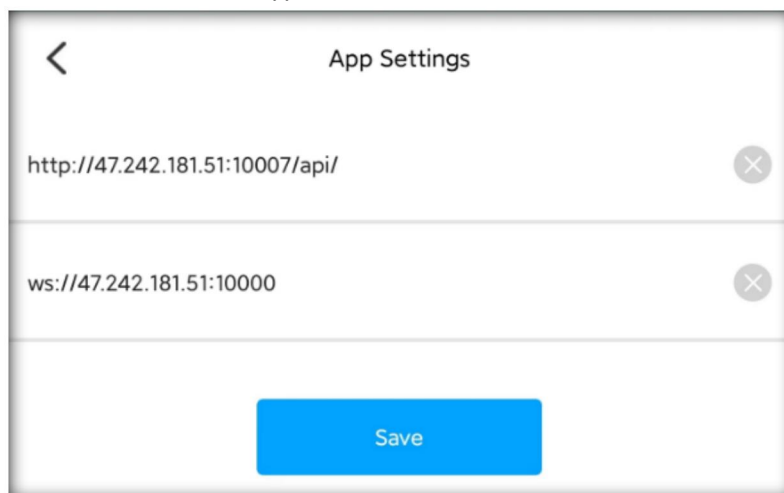

## 2. Wi-Fi Connection by APP

Please note that if you want to use the APP to connect Wi-Fi to the helmet, your phone needs to turn on Bluetooth and connect to Wi-Fi, helmet is power on, the helmet will automatically recognize your current phone's Wi-Fi.

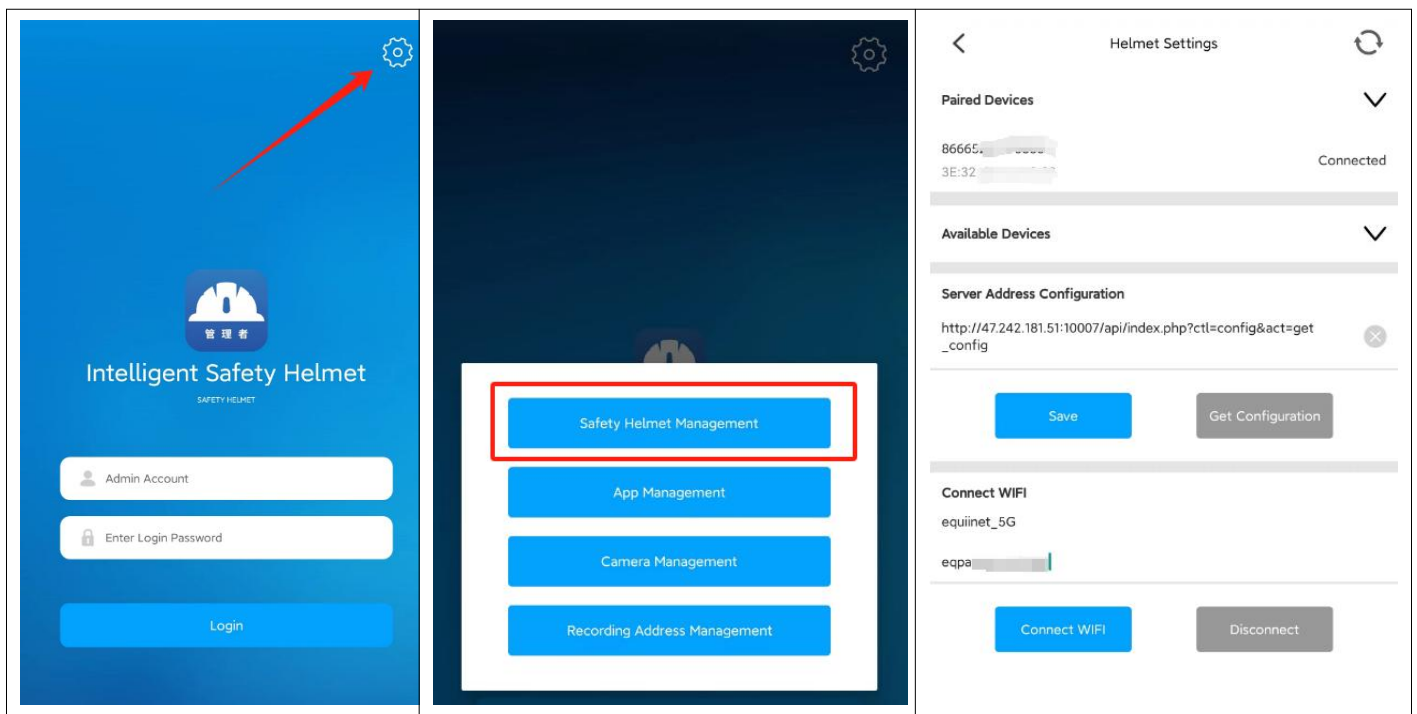

In Helmet Settings page, You will see there is a helmet's ID in available device. You need to tap on it to pair. After paired, the server address configuration will automatically fill in an address. If not same as the picture three, please modify it. Then input your Wi-Fi password to connect.

Server Address Configuration:  
[http://47.242.181.51:10007/api/index.php?ctl=config&act=get\\_config](http://47.242.181.51:10007/api/index.php?ctl=config&act=get_config)

### 3. Login

If you are using administrator APP, the login account is the same as the website account.

If you are using personal APP, the login account is the username of helmet, the password is the APP password of helmet.

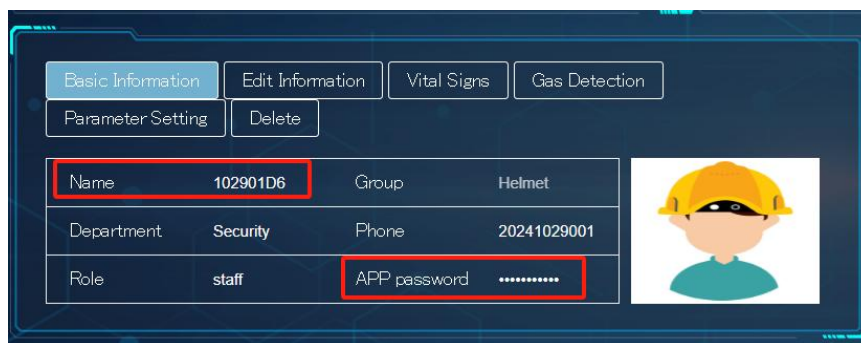

### 4. Device Management

After login, you can see all helmets in monitoring page. In personal APP, only one helmet.

Most usage of features are same between admin and personal APP.

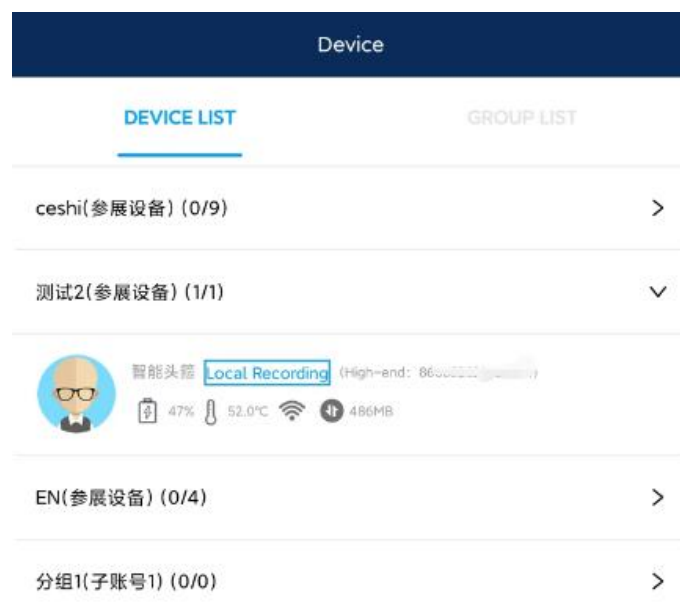



Administrator APP Interface



Personal APP Interface

Tap on helmet to use more features.

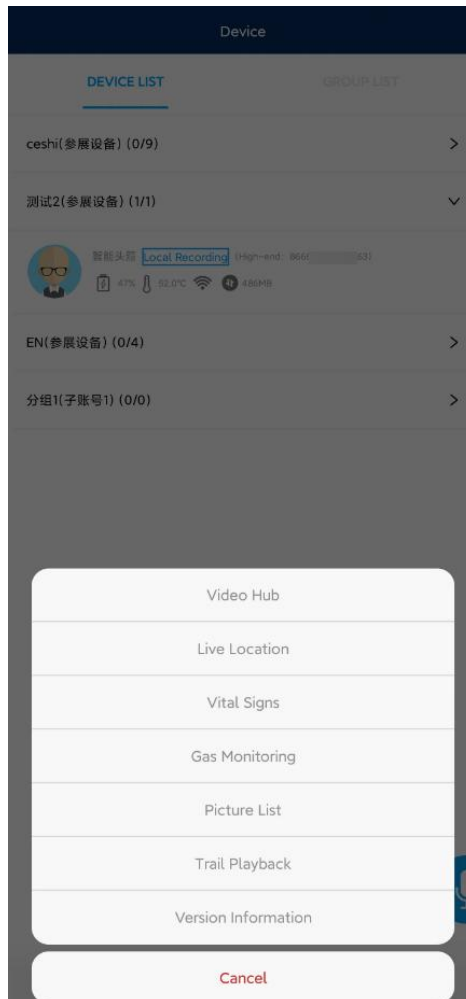

Administrator APP Features

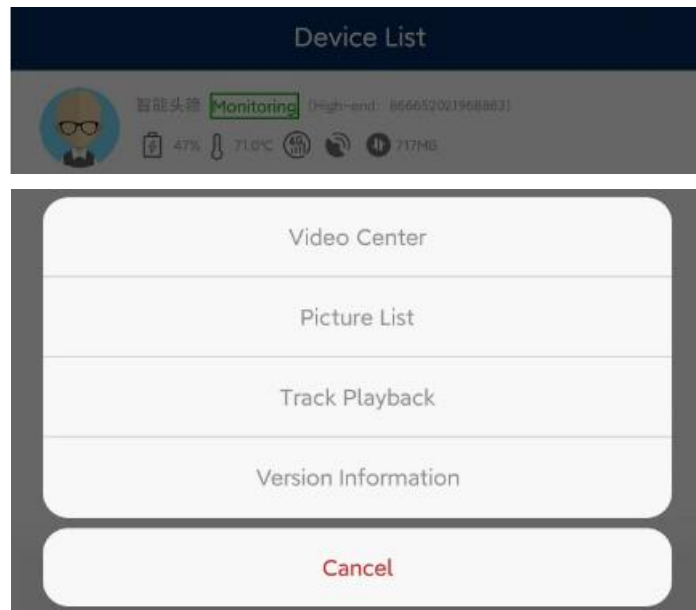

Personal APP Features

**Video Hub:** You can monitor and make a real time call with this helmet in here.(Note: Only few features in control center are work, because this is a test demo)

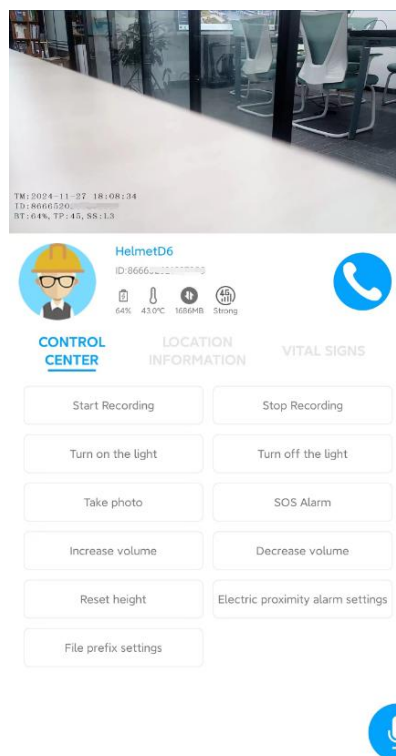

**Live Location:** Not support in this server now. Because this is a test demo, without google map.

**Vital Signs&Gas Monitoring:** Need to be work with vital signs wristband.

**Picture List:** Check all pictures taken by this helmet.

**Trail Playback:** Not support in this server now. Because this is a test demo, without google map.

You can check the task details and publish task in Task page. Like not started, in progress, completed and incompleted tasks.

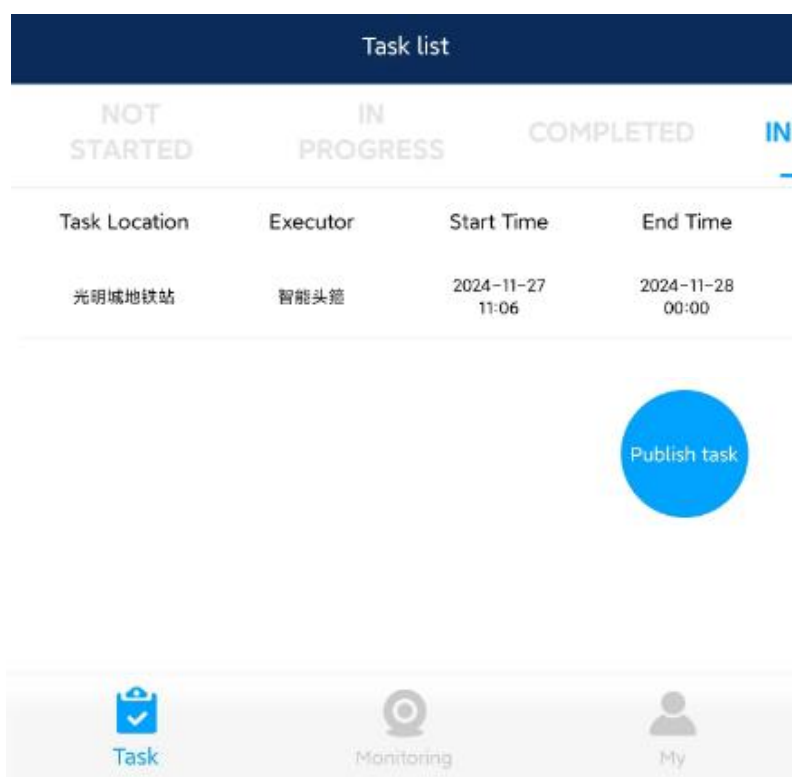

**Emergency Services:** Check helmets alarm record.

**Change password:** Change the password of this account.

**Electronic Fence:** Check the existed fence.







**Version Information:** Current APP version.

**Language:** Switch APP language.

 20240101001  
参展设备

Department: 安防部

Position: 安防

-  Emergency services >
-  Change password >
-  Electronic Fence >
-  Version information >
-  Language >
-  Logout >